



**Two Doors Pizzatable
Marble Top Saladette**

ESL3831



Two Doors Open Top Saladette

ESL3832

FEATURES

- Performs well in hot environments
- High grade stainless steel interior and exterior
- Heavy duty marble prep area - ESL3831
- Heavy duty stainless steel top - ESL3832
- All fitted with European parts Compressor and EBM fan motor
- Embraco compressor
- 43-degree ambient working temperature
- Gas 134A refrigerant
- -2 to 8 degrees working temp
- Insulation foam CH10, ODP zero emissions
- Static cooling system
- Carel Italian digital controls
- Self-evaporating drainage
- Manual defrosting system
- We recommend you defrost regularly for better maintenance of temperatures
- Compressor and condenser situated on the bottom, so motor can breathe
- Unit can be positioned against a wall
- Fits Australian GN pans
- White Epoxy shelves and stainless steel rails
- Comes installed with 4 castors for easy mobility
- ESL3831 fits 5 x 1/6 GN Pans 100mm deep
- ESL3832 fits 5 x 1/6 GN Pans 100mm deep
- GN / pans and Lids not included



SALADETTES

ESL3831

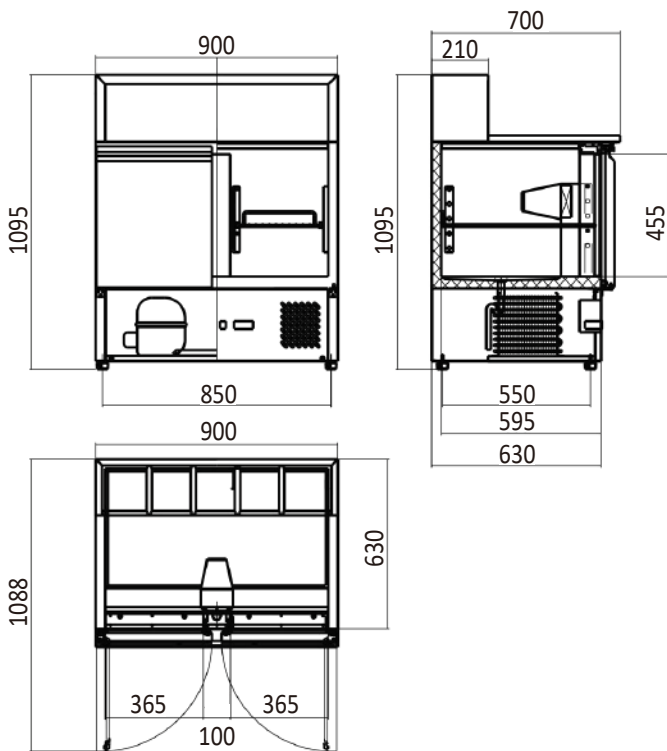

ESL3832

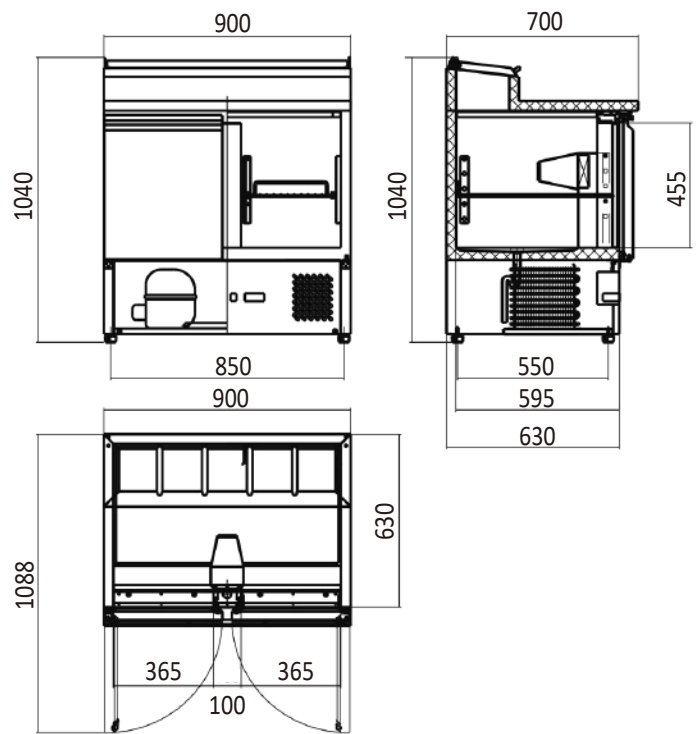

INFORMATION	ESL3831	ESL3832
Capacity	300L	300L
Power	250W	250W
Voltage	220~240V/50Hz	220~240V/50Hz
Working Temp	-2°C~+8°C	-2°C~+8°C
Ambient Temp	43°C	43°C
Dimensions(mm)	W900 x D700 x H1100,92kg	W900 x D700 x H1040,68kg
Packaging Dimensions(mm)	W954 x D754 x H1242,108kg	W954 x D754 x H1172,84kg



2 YEARS WARRANTY ON ALL PARTS AND LABOUR
EXTRA 2 YEARS WARRANTY ON PARTS
WHEN YOU REGISTER WITH US ONLINE



* All prices are EX-GST