



**Three Doors Sliding Lid Saladette**

**ESL3850**



**Three Doors Table Saladette**

**ESL3851**

## FEATURES

- Performs well in hot environments
- High grade stainless steel interior and exterior
- Sliding lid cover on the ESL3850
- Heavy duty stainless steel top prep area
- All fitted with European parts Compressor and EBM fan motor
- Aspera compressor
- 43-degree ambient working temperature
- Gas 134A refrigerant
- Insulation foam CH10, ODP zero emissions
- STATIC COOLING SYSTEM
- Carel / Dixell Italian digital controls
- Self-evaporating drainage
- Manual defrosting system
- We recommend you defrost regularly for better maintenance of temperatures
- Compressor and condenser situated on the bottom, so motor can breathe
- Unit can be positioned against a wall
- Fits Australian GN pans
- 3 Self-closing doors
- White Epoxy shelves and stainless steel rails
- Comes installed with 4 castors for easy mobility
- ESL3850 can fit 12 x 1/3 GN Pans 100mm deep
- G/N pans and Lids are not included



ESL3850

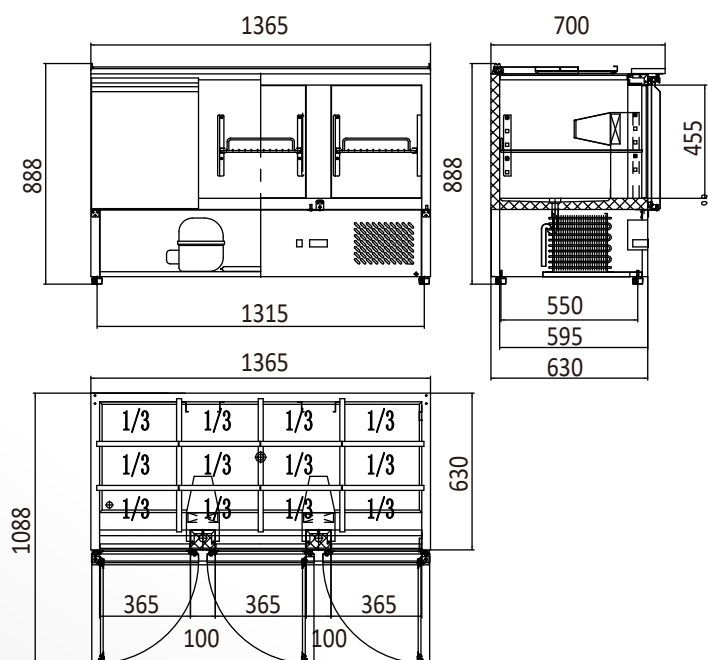

ESL3851

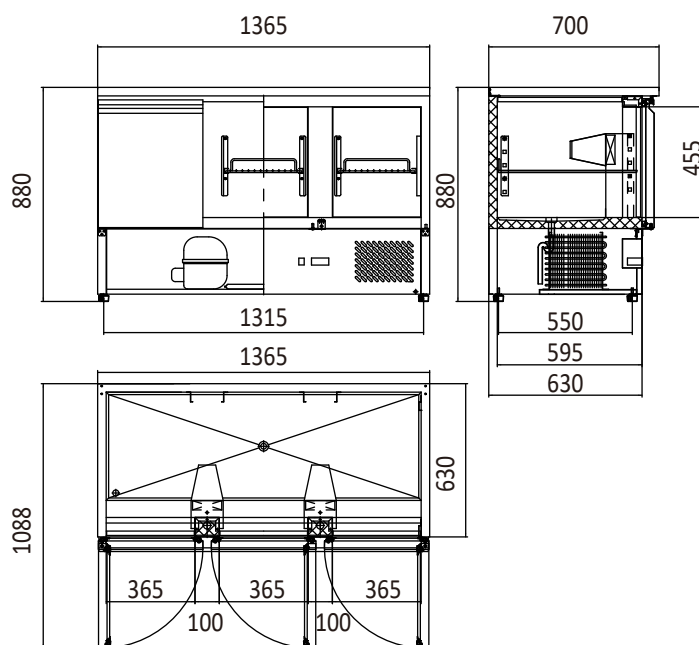

INFORMATION	ESL3850	ESL3851
Capacity	380L	380L
Power	300W	300W
Voltage	220~240V/50Hz	220~240V/50Hz
Working Temp	-2°C~+8°C	-2°C~+8°C
Ambient Temp	43°C	43°C
Dimensions(mm)	W1365 x D700 x H888,90kg	W1365 x D700 x H880,90kg
Packaging Dimensions(mm)	W1419 x D754 x H1022,105kg	W1419 x D754 x H1022,105kg



2 YEARS WARRANTY ON ALL PARTS AND LABOUR  
EXTRA 2 YEARS WARRANTY ON PARTS  
WHEN YOU REGISTER WITH US ONLINE



\* All prices are EX-GST